

<p>Поддержка кабеля проходная</p>		<p>13 - 14</p>
<p>Защитные трубы</p>		<p>17 - 110</p>
<p>Система подвеса светильников</p>		<p>113 - 115</p>
<p>Судовые лестничные лотки</p>		<p>117 - 120</p>
<p>Напольные каналы</p>		<p>123 - 130</p>

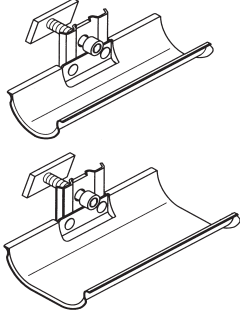

Поддержка кабеля проходная

KTW-R

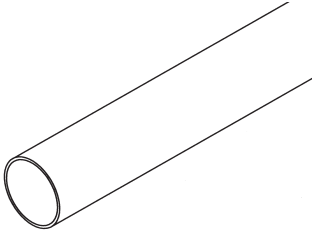
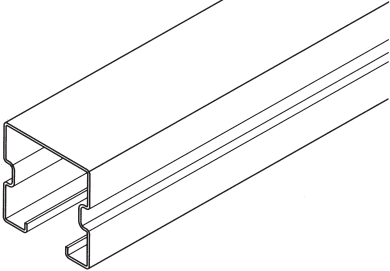
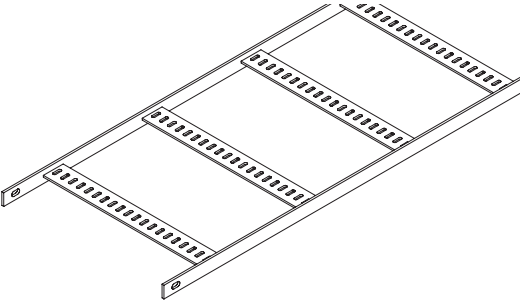
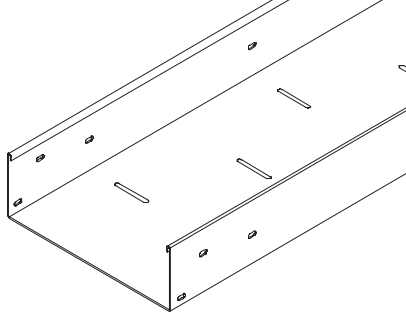
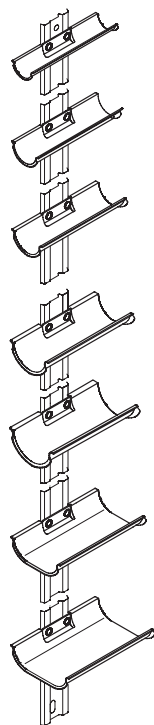
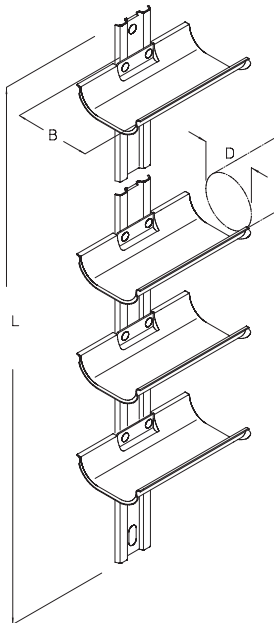

- KTW-R 4
- KTW-R 5
- KTW-R 6
- KTW-R 7
- KTW-R 8
- KTW-R 10
- KTW-R 12

F

	L	D	B	
	mm	mm	mm	kg
KTW-R 10/2	237	100	118	1,1
KTW-R 10/3	329	100	118	1,6
KTW-R 10/4	421	100	118	2,1
KTW-R 10/5	518	100	118	2,6
KTW-R 10/6	605	100	118	3,1
KTW-R 10/7	697	100	118	3,6
KTW-R 10/8	789	100	118	4,2
KTW-R 10/9	881	100	118	4,7
KTW-R 10/10	973	100	118	5,2

KTW-R 4	40	56
KTW-R 5	50	66
KTW-R 6	60	76
KTW-R 7	70	86
KTW-R 8	80	97
KTW-R 10	100	118
KTW-R 12	120	138

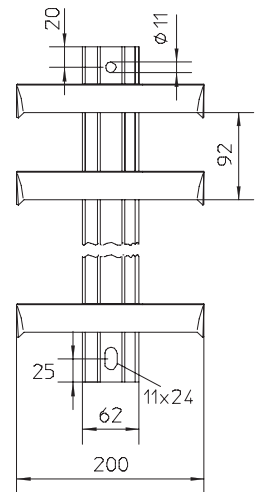

Поддержка кабеля проходная

КТW-A

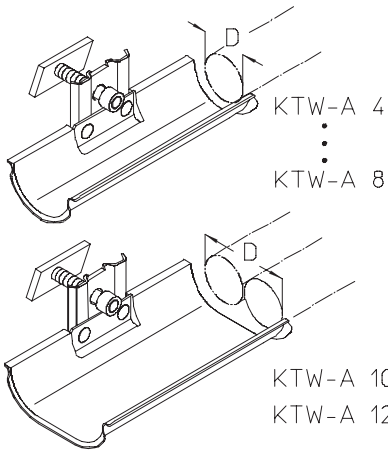

F

- КТW-A 4
- КТW-A 5
- КТW-A 6
- КТW-A 7
- КТW-A 8

- КТW-A 10
- КТW-A 12

D	B	
mm	mm	kg
40	56	0,30
50	66	0,32
60	76	0,35
70	86	0,39
80	96	0,44
100	118	0,48
120	138	0,55

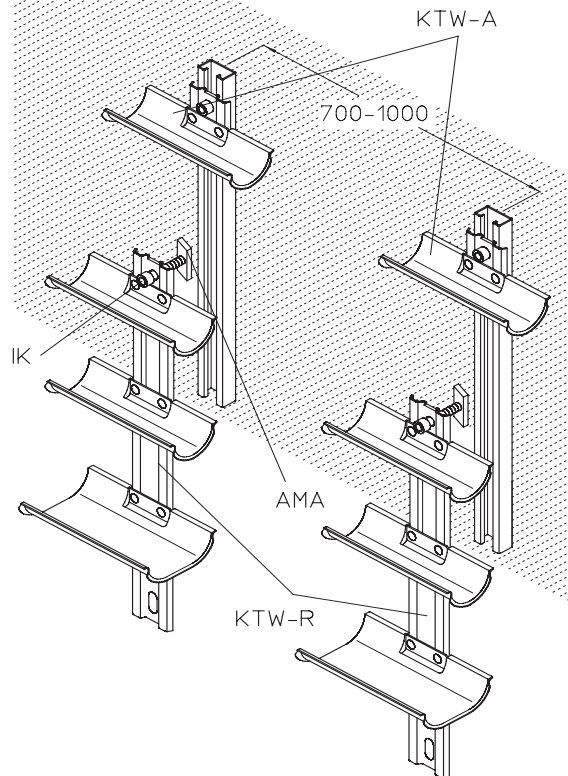
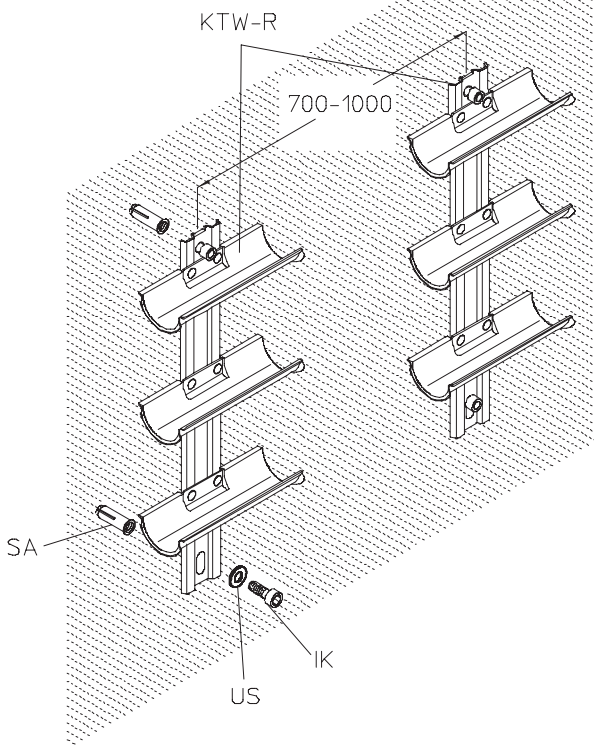
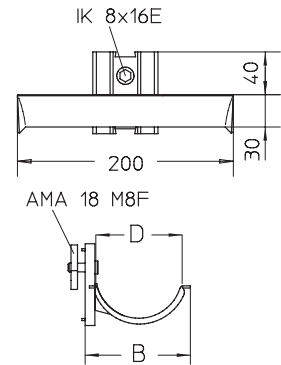



A large, empty rectangular box with a thin black border, intended for taking notes.



Защитные трубы

SR
Защитная труба

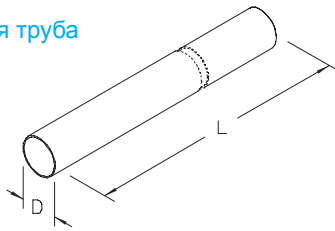

SRL
Защитная труба, с перфорацией

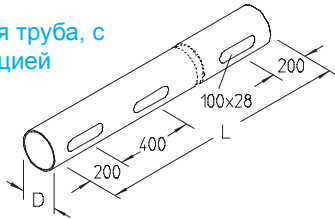

SRB
Поворот трубы 90° / 45°

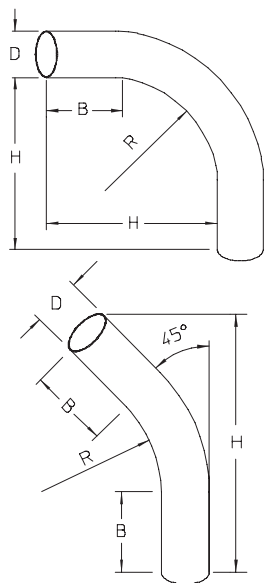

SRM
Зажимная муфта

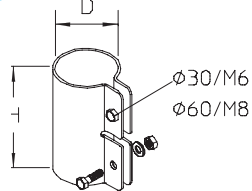

SRML
Зажимная муфта, с перфорацией

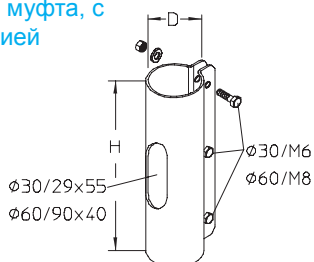

H	B	S	L	D	
mm	mm	mm	mm	mm	kg

F E

SR 30F		1,5	6000	30	6,65
SR 30E		1,5	6000	30	6,65
SR 60F		2,0	6000	60	17,40
SR 60E		2,0	6000	60	17,40

F E

SRL 60F		2,0	6000	60	16,30
SRL 60E		2,0	6000	60	16,30

H	B	S	R	D	
mm	mm	mm	mm	mm	kg

F E

SRB 90-30F	185	100	1,5	140	30	0,40
SRB 90-30E	185	100	1,5	140	30	0,40
SRB 90-60F	225	100	2,0	150	60	1,30
SRB 90-60E	225	100	2,0	150	60	1,30

SRB 45-30F	270	100	1,5	140	30	0,30
SRB 45-30E	270	100	1,5	140	30	0,30
SRB 45-60F	350	100	2,0	150	60	1,05
SRB 45-60E	350	100	2,0	150	60	1,05

F E

SRM 30F	80		1,5		30	0,15
SRM 30E	80		1,5		30	0,15
SRM 60F115			2,5		60	0,55
SRM 60E115			2,5		60	0,55

F E

SRML 30F	130		1,5		30	0,20
SRML 30E	130		1,5		30	0,20
SRML 60F	180		2,5		60	1,05
SRML 60E	180		2,5		60	1,05

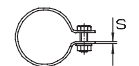
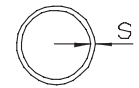
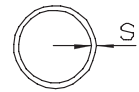
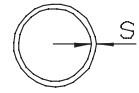

Защитные трубы

SRHD

Держатель защитной трубы, поворотный

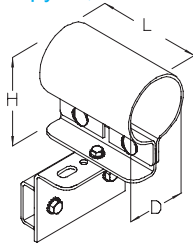

SRHB

Держатель защитной трубы

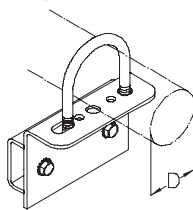

SRSB

Переходник

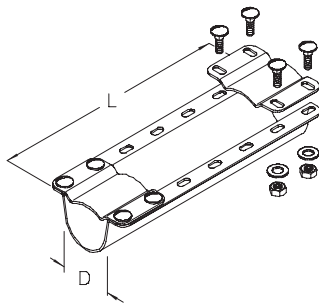

SRS-R

Хомут

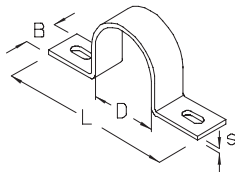

SRS-B

Хомут подвесной

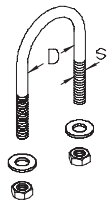

SRS-A

Хомут на стяжке

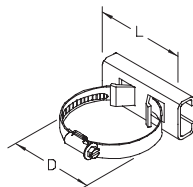

	H	B	S	L	D	
	mm	mm	mm	mm	mm	kg
F E						
SRHD 30F	62	1,5	1,5	80	30	0,70
SRHD 30E	62	1,5	1,5	80	30	0,70
SRHD 60F	102	1,5	2,0	115	60	1,20
SRHD 60E	102	1,5	2,0	115	60	1,20
F E						
SRHB 30F	6	1,5			30	0,52
SRHB 30E	6	1,5			30	0,52
SRHB 60F	10	2,0			60	0,62
SRHB 60E	10	2,0			60	0,62
F E						
SRSB 30-300F	85	2,0	300	30		1,05
SRSB 30-400F	85	2,0	400	30		1,28
SRSB 30-500F	85	2,0	500	30		1,52
SRSB 30-600F	85	2,0	600	30		1,75
SRSB 30-300E	85	2,0	300	30		1,05
SRSB 30-400E	85	2,0	400	30		1,28
SRSB 30-500E	85	2,0	500	30		1,52
SRSB 30-600E	85	2,0	600	30		1,75
SRSB 60-300F	120	2,5	300	60		2,00
SRSB 60-400F	120	2,5	400	60		2,20
SRSB 60-500F	120	2,5	500	60		2,60
SRSB 60-600F	120	2,5	600	60		3,00
SRSB 60-300E	120	2,5	300	60		2,00
SRSB 60-400E	120	2,5	400	60		2,44
SRSB 60-500E	120	2,5	500	60		2,89
SRSB 60-600E	120	2,5	600	60		3,33
F E						
SRS-R 30F	25	2,5	85	31		0,06
SRS-R 30E	25	2,5	85	31		0,06
SRS-R 60F	30	4,0	160	61		0,22
SRS-R 60E	30	4,0	160	61		0,22
F E						
SRS-B 30-6F		6,0		31		0,03
SRS-B 30-6E		6,0		31		0,03
SRS-B 60-10F		10,0		61		0,22
SRS-B 60-8E		8,0		61		0,22
F E						
SRS-A 30F				70	30	0,06
SRS-A 30E				70	30	0,06
SRS-A 60F				70	60	0,08
SRS-A 60E				70	60	0,08

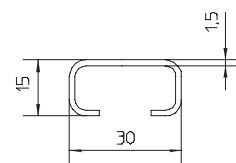
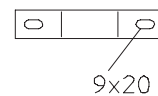
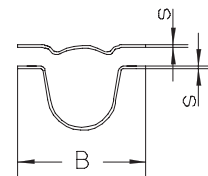
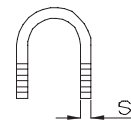
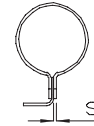

Защитные трубы

SRS-W

Хомут двухсторонний

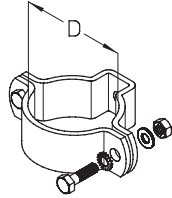

F E

	H	B	S	L	D	
	mm	mm	mm	mm	mm	kg
SRS-W 30F					31	0,21
SRS-W 30E					31	0,21
SRS-W 60F					61	0,31
SRS-W 60E					61	0,31

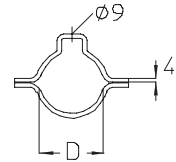

SRMP

Монтажная пластина

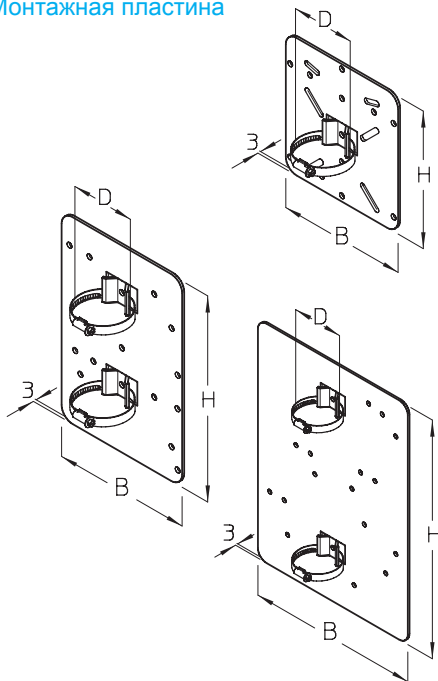

F E

SRMP-A 30F	175	165			30	0,58
SRMP-A 30E	175	165			30	0,58
SRMP-A 60F	175	165			60	0,60
SRMP-A 60E	175	165			60	0,60

F E

SRMP-B 30F	260	175			30	1,00
SRMP-B 30E	260	175			30	1,00
SRMP-B 60F	260	175			60	1,00
SRMP-B 60E	260	175			60	1,00

Другие размеры доступны под заказ.

SRMP-C 60F	380	270			60	2,70
SRMP-C 60E	380	270			60	2,70

SRF

Держатель напольный

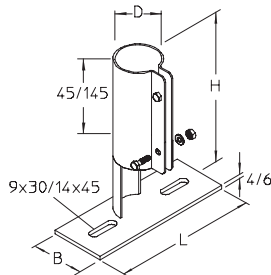

F E

SRF 30F	130	40	1,5	130	31	0,28
SRF 30E	130	40	1,5	130	31	0,28
SRF 60F	230	80	2,5	220	61	1,75
SRF 60E	230	80	2,5	220	61	1,75

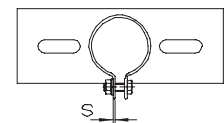

SRFW

Напольная угловая консоль

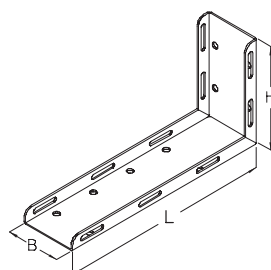

F E

SRFW 30F	100	60		200		0,52
SRFW 30E	100	60		200		0,52
SRFW 60F	200	100		400		1,95
SRFW 60E	200	100		400		1,95

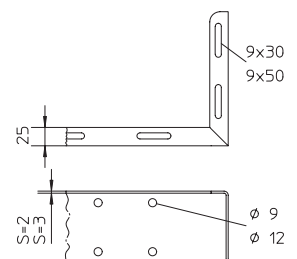

Защитные трубы

SRK-O
Защитная втулка

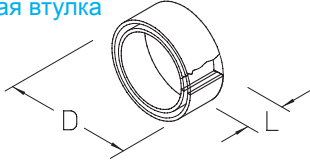

SRK-G
Заглушка

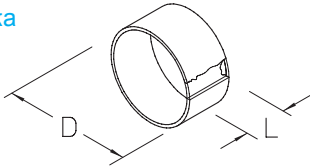

PVC

SRK-O 30

L	D	
mm	mm	kg

25	30	0,01
----	----	------

SRK-O 60

25	60	0,02
----	----	------

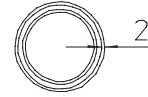

PVC

SRK-G 30

30	30	0,01
----	----	------

SRK-G 60

35	60	0,02
----	----	------

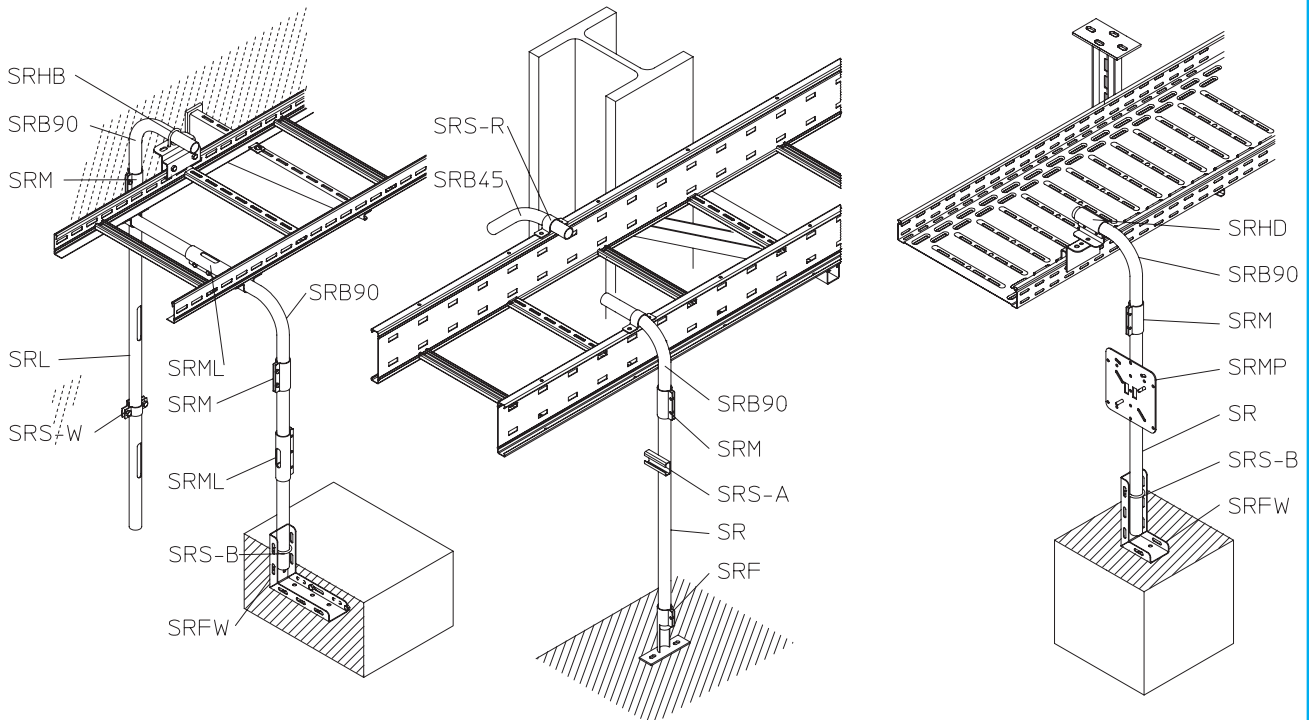
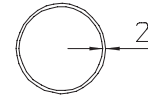



A large, empty rectangular box with a thin black border, intended for taking notes.



Система подвеса светильников

KPR 40
Подвесной каркас

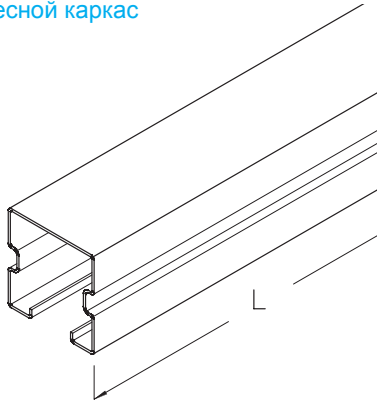

KPV
Соединитель

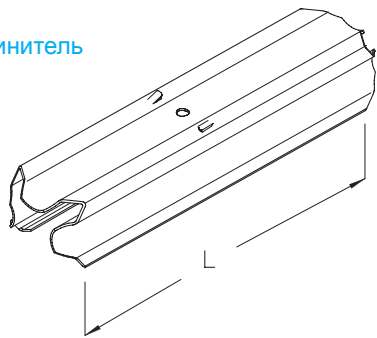

KPD
Крышка

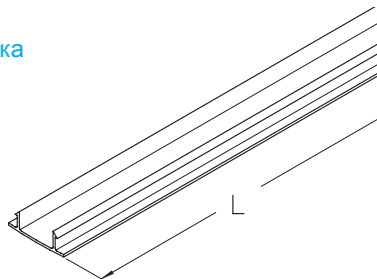

S
KPR 40-3
KPR 40

L	kg
3000	5,40
6000	10,80

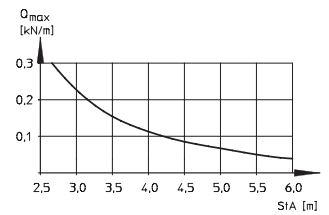
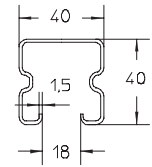

S
KPV

300	0,31
-----	------

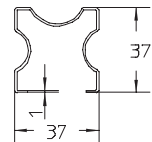

PVC
KPD-3
KPD

3000	0,21
6000	0,42

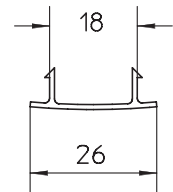

RAL 7011

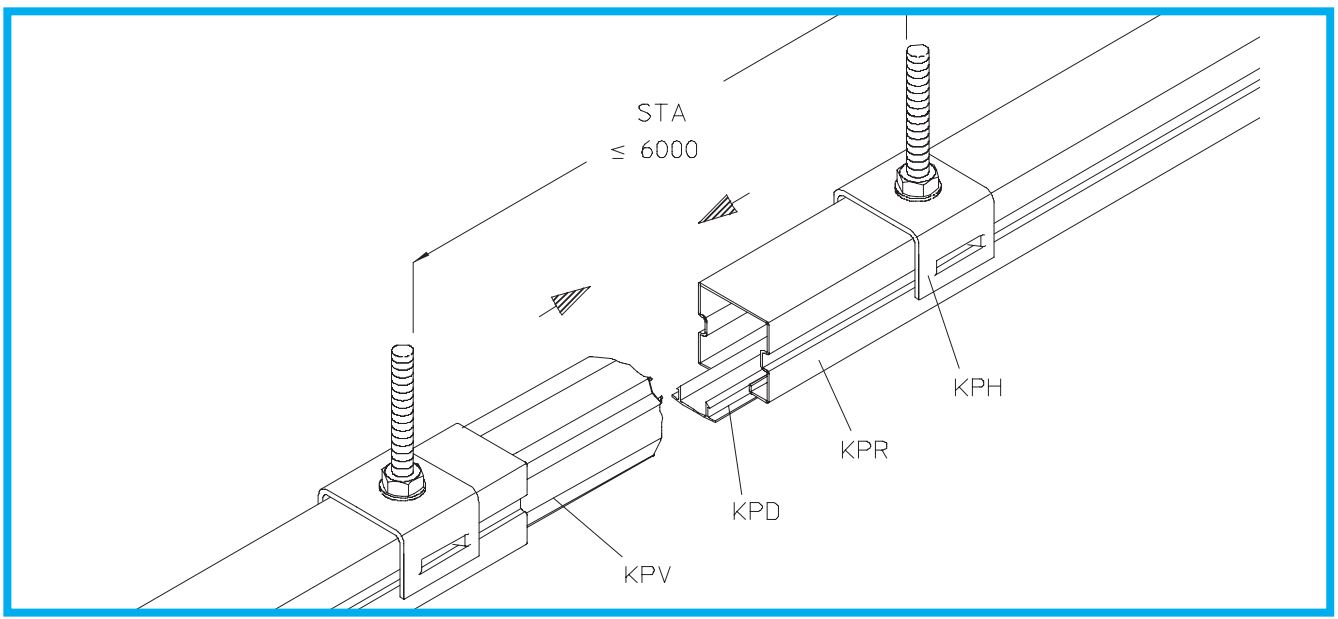

Система подвеса светильников

KPE
Заглушка

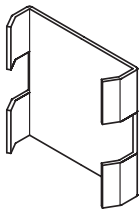

S
KPE

D
mm

kg/100

2,2

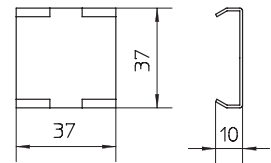

AM 8 M5
Анкерная гайка

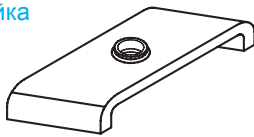

F
AM 8 M5

1,6

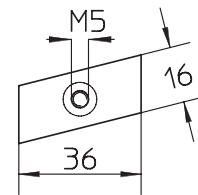

KPB
Подвесная скоба

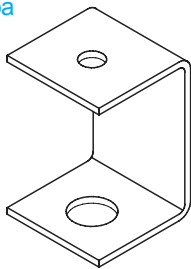

F
KPB

11,0

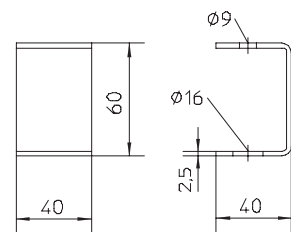

KPH
Каркасная скоба

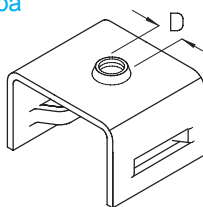

F
KPH 8
KPH-PG 9

M8
R 3/8"
(= 9,53 mm)

7,8
6,0

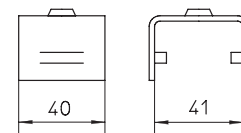

➔ DAS 8x30
SHS 8x45

G7
G7

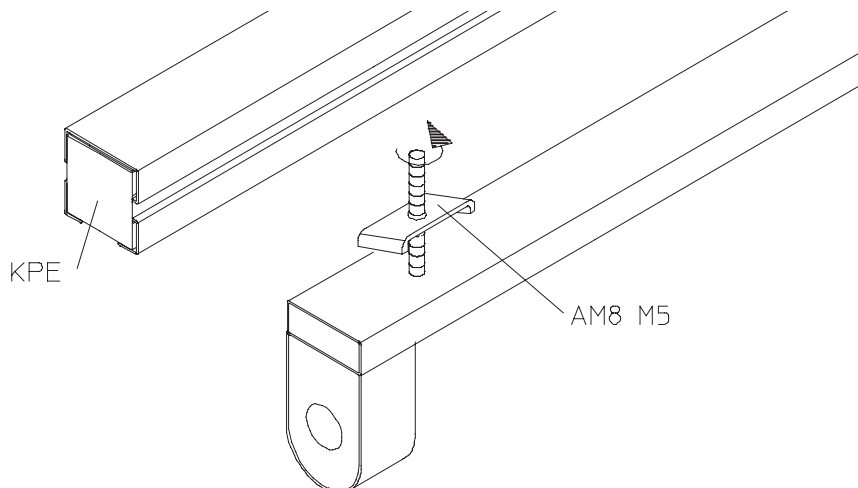

Система подвеса светильников

SMH
Контргайка

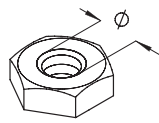

KNK-NG
Соединитель для цепи



SMH 8
SMH-PG 9

KNK-NG

Ø	D	d	
Zoll	mm	mm	kg/100

M 8	13	4	0,31
R 3/8"	27	6	1,93

		3	0,36
--	--	---	------

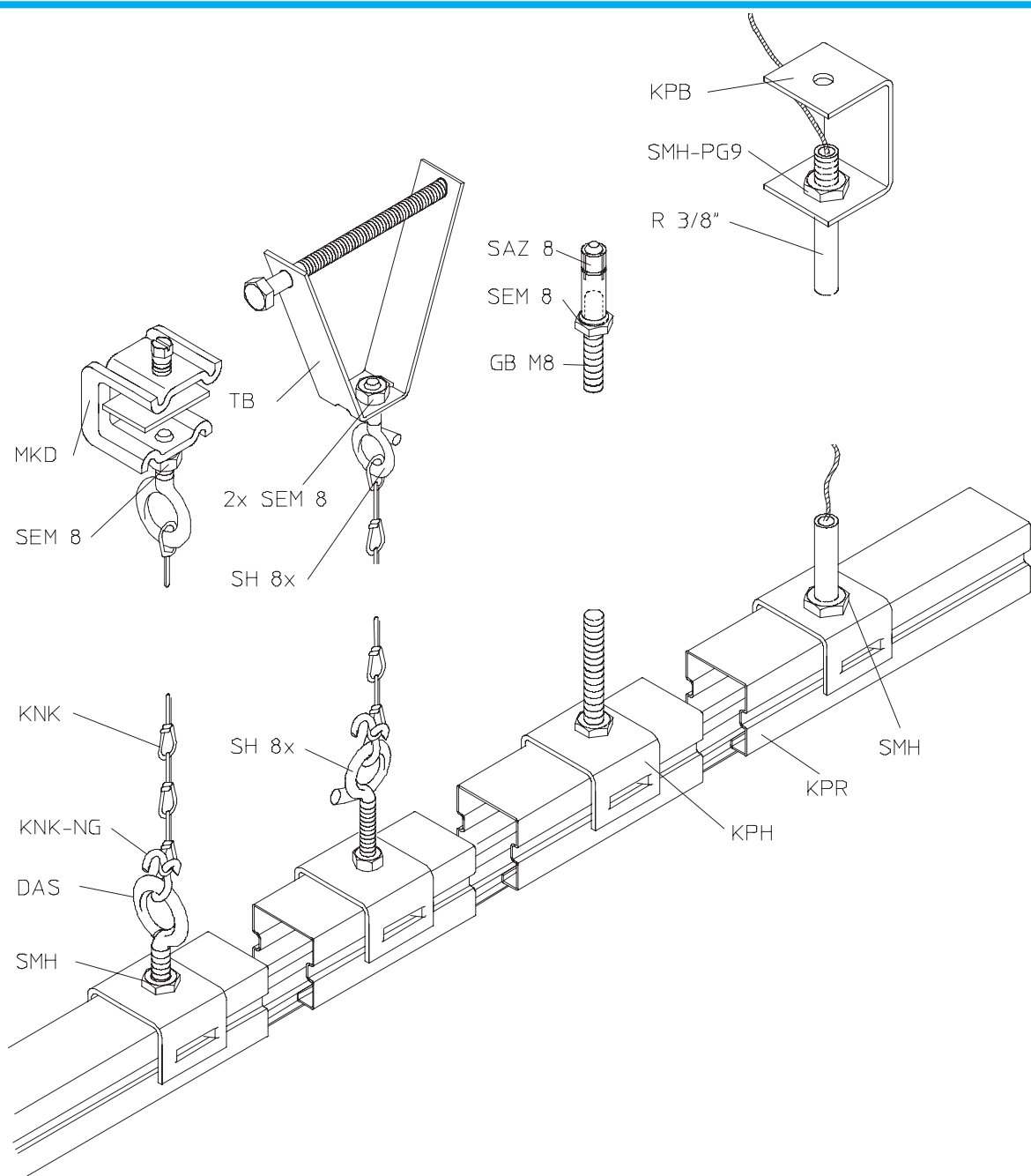
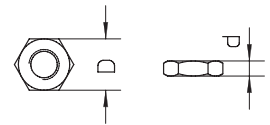



Судовые лестничные лотки

SKL

Судовой лестничный лоток

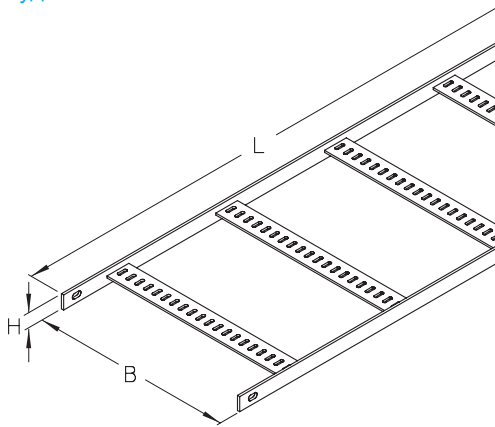

B F M

	B	H	L	
	mm	mm	mm	kg
SKL 075B	75	30	3000	8,4
SKL 100B	100	30	3000	8,7
SKL 150B	150	30	3000	9,3
SKL 200B	200	30	3000	9,9
SKL 250B	250	30	3000	10,8
SKL 300B	300	30	3000	11,4
SKL 400B	400	30	3000	12,9
SKL 500B	500	30	3000	14,4
SKL 075F	75	30	3000	8,4
SKL 100F	100	30	3000	8,7
SKL 150F	150	30	3000	9,3
SKL 200F	200	30	3000	9,9
SKL 250F	250	30	3000	10,8
SKL 300F	300	30	3000	11,4
SKL 400F	400	30	3000	12,9
SKL 500F	500	30	3000	14,4
SKL 075M	75	30	3000	8,4
SKL 100M	100	30	3000	8,7
SKL 150M	150	30	3000	9,3
SKL 200M	200	30	3000	9,9
SKL 250M	250	30	3000	10,8
SKL 300M	300	30	3000	11,4
SKL 400M	400	30	3000	12,9
SKL 500M	500	30	3000	14,4



SLV, SLVV, SLW

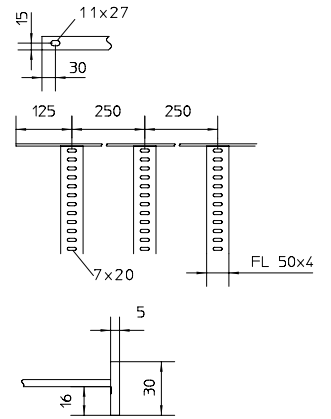

Судовые лестничные лотки

SLB

Угол горизонтальный

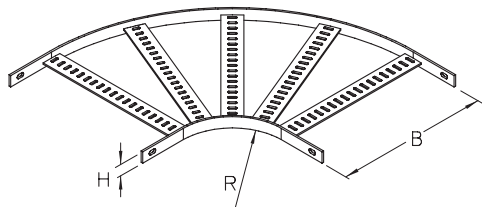

B F M

	B	H	R	
	mm	mm	mm	kg
SLB 075B	75	30	150	1,6
SLB 100B	100	30	150	1,7
SLB 150B	150	30	150	2,0
SLB 200B	200	30	150	2,2
SLB 250B	250	30	150	2,8
SLB 300B	300	30	150	3,7
SLB 400B	400	30	150	4,5
SLB 500B	500	30	150	6,1
SLB 075F	75	30	150	1,6
SLB 100F	100	30	150	1,7
SLB 150F	150	30	150	2,0
SLB 200F	200	30	150	2,2
SLB 250F	250	30	150	2,8
SLB 300F	300	30	150	3,7
SLB 400F	400	30	150	4,5
SLB 500F	500	30	150	6,1
SLB 075M	75	30	150	1,6
SLB 100M	100	30	150	1,7
SLB 150M	150	30	150	2,0
SLB 200M	200	30	150	2,2
SLB 250M	250	30	150	2,8
SLB 300M	300	30	150	3,7
SLB 400M	400	30	150	4,5
SLB 500M	500	30	150	6,1

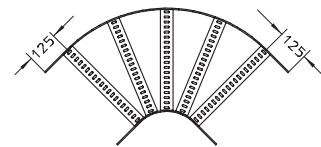

⇒ SLV, SLVV, SLW



SLS

Угол вертикальный

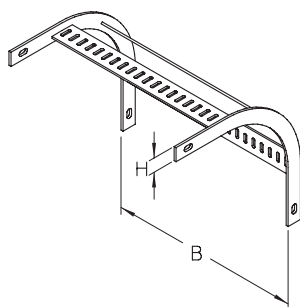

B F M

SLS 075B	75	30	150	0,9
SLS 100B	100	30	150	1,0
SLS 150B	150	30	150	1,0
SLS 200B	200	30	150	1,3
SLS 250B	250	30	150	1,5
SLS 300B	300	30	150	1,7
SLS 400B	400	30	150	2,8
SLS 500B	500	30	150	3,3
SLS 075F	75	30	150	0,9
SLS 100F	100	30	150	1,0
SLS 150F	150	30	150	1,0
SLS 200F	200	30	150	1,3
SLS 250F	250	30	150	1,5
SLS 300F	300	30	150	1,7
SLS 400F	400	30	150	2,8
SLS 500F	500	30	150	3,3
SLS 075M	75	30	150	0,9
SLS 100M	100	30	150	1,0
SLS 150M	150	30	150	1,0
SLS 200M	200	30	150	1,3
SLS 250M	250	30	150	1,5
SLS 300M	300	30	150	1,7
SLS 400M	400	30	150	2,8
SLS 500M	500	30	150	3,3

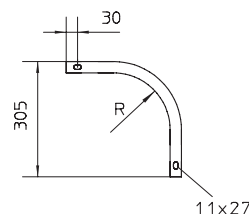

⇒ SLV, SLVV, SLW



Судовые лестничные лотки

SLA

T-образный отвод

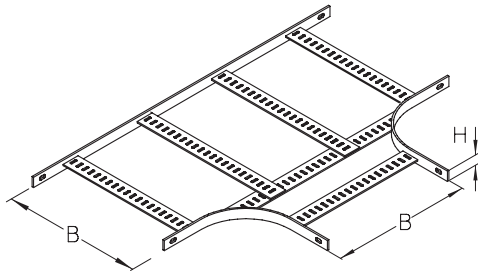

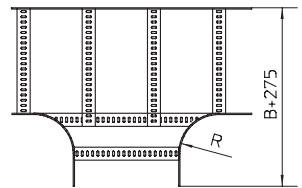

	B	H	R	
	mm	mm	mm	kg
B F M				
SLA 075B	75	30	150	2,5
SLA 100B	100	30	150	2,7
SLA 150B	150	30	150	3,2
SLA 200B	200	30	150	3,6
SLA 250B	250	30	150	4,1
SLA 300B	300	30	150	5,4
SLA 400B	400	30	150	6,5
SLA 500B	500	30	150	8,8
SLA 075F	75	30	150	2,5
SLA 100F	100	30	150	2,7
SLA 150F	150	30	150	3,2
SLA 200F	200	30	150	3,6
SLA 250F	250	30	150	4,1
SLA 300F	300	30	150	5,4
SLA 400F	400	30	150	6,5
SLA 500F	500	30	150	8,8
SLA 075M	75	30	150	2,5
SLA 100M	100	30	150	2,7
SLA 150M	150	30	150	3,2
SLA 200M	200	30	150	3,6
SLA 250M	250	30	150	4,1
SLA 300M	300	30	150	5,4
SLA 400M	400	30	150	6,5
SLA 500M	500	30	150	8,8

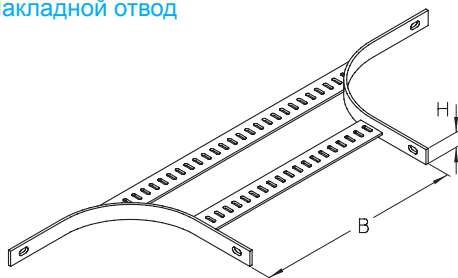

SLAA

Накладной отвод



	B	H	R	
	mm	mm	mm	kg
B F M				
SLAA 075B	75	30	150	1,4
SLAA 100B	100	30	150	1,5
SLAA 150B	150	30	150	1,7
SLAA 200B	200	30	150	1,8
SLAA 250B	250	30	150	2,0
SLAA 300B	300	30	150	2,5
SLAA 400B	400	30	150	2,8
SLAA 500B	500	30	150	3,4
SLAA 075F	75	30	150	1,4
SLAA 100F	100	30	150	1,5
SLAA 150F	150	30	150	1,7
SLAA 200F	200	30	150	1,8
SLAA 250F	250	30	150	2,0
SLAA 300F	300	30	150	2,5
SLAA 400F	400	30	150	2,8
SLAA 500F	500	30	150	3,4
SLAA 075M	75	30	150	1,4
SLAA 100M	100	30	150	1,5
SLAA 150M	150	30	150	1,7
SLAA 200M	200	30	150	1,8
SLAA 250M	250	30	150	2,0
SLAA 300M	300	30	150	2,5
SLAA 400M	400	30	150	2,8
SLAA 500M	500	30	150	3,4

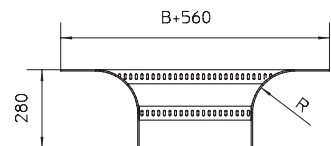

⇒ SLV, SLVV, SLW 

Судовые лестничные лотки

SLV
Соединитель

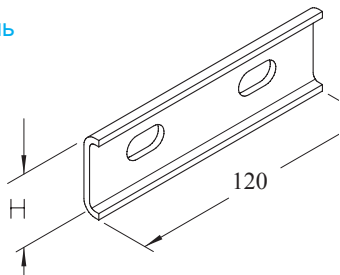

B F M

	B	H	R	kg
SLV B	120	38		0,1
SLV F	120	38		0,1
SLV M	120	38		0,1

Вкл. 2 x KLS 10x20F

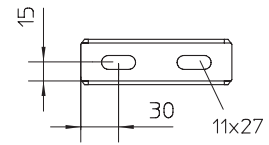

SLVV
Соединитель вертикальный
изменяемый

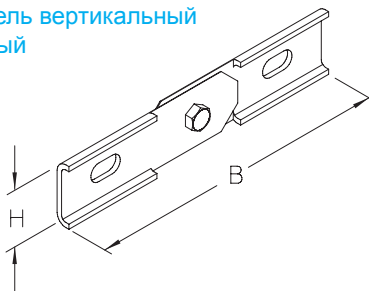

B F M

	B	H	R	kg
SLVV B	180	38		0,2
SLVV F	180	38		0,2
SLVV M	180	38		0,2

Вкл. 2 x KLS 10x20F
1 x SES 10x20F
1 x SEM 10F
1 x US 10x21F

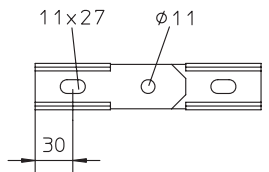

SLW
Крепежный уголок

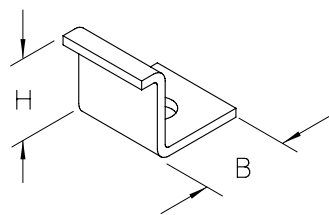

B F M

	B	H	R	kg
SLW 7B			7	0,1
SLW 7F			7	0,1
SLW 7M			7	0,1

Вкл. 1 x SES 6x20E
1 x US 6x12E
1 x SEM 6E



SLW 10B			11	0,1
SLW 10F			11	0,1
SLW 10M			11	0,1

Вкл. 1 x SES 10x20F
1 x SEM 10F
1 x US 10x21F



SLF
Крепежный крюк

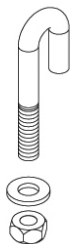

F

	B	H	R	kg/100
SLF				3,41
SLF F				3,41
SLF E				3,41

Вкл. 1 x US 8x17
1 x SEM 8



kg/100





A large, empty rectangular box with a thin black border, intended for taking notes.

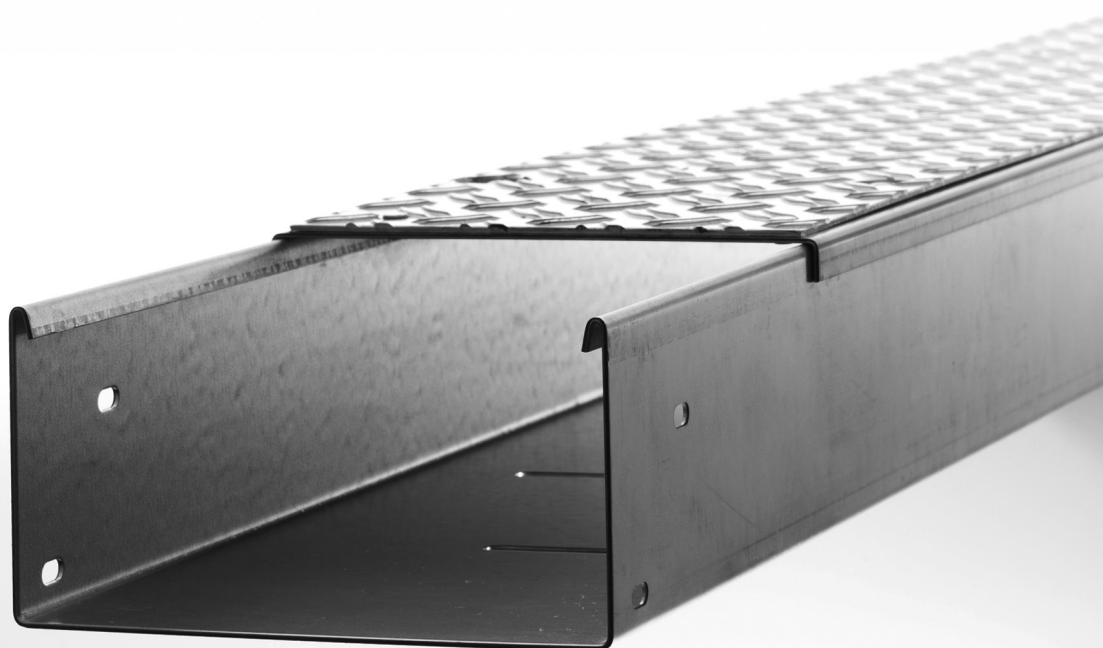

Напольные каналы

БК
Подпольный канал,
перфорированный

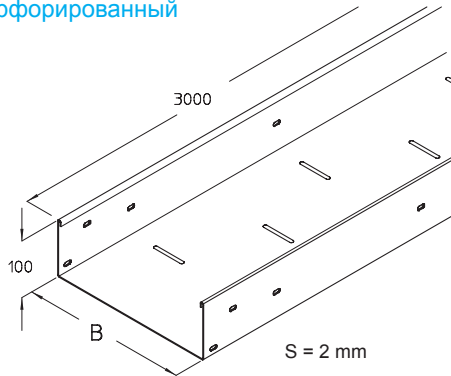

БКOS
Подпольный канал,
неперфорированный

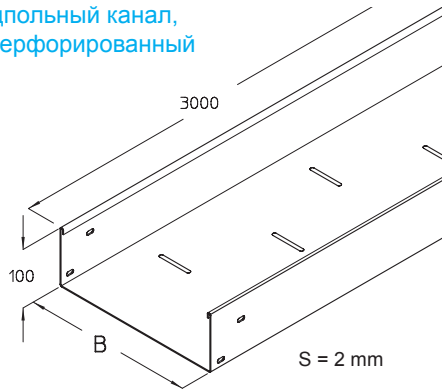

БКВ
Угол горизонтальный

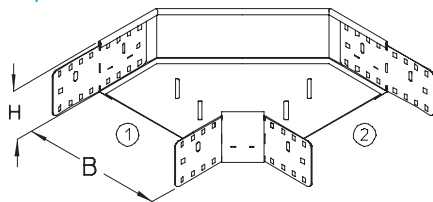

БКВ45
Угол горизонтальный

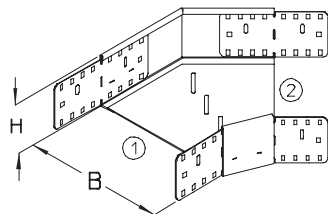

S

	B	H	
	mm	mm	kg
BK 100-10S	100	100	15,1
BK 100-20S	200	100	20,1
BK 100-30S	300	100	25,1
BK 100-40S	400	100	30,1
BK 100-50S	500	100	34,9
BK 100-60S	600	100	39,7

⇒ BKV 100
BKDR
BKDR-WZB

S

BKOS 100-10S	100	100	15,1
BKOS 100-20S	200	100	20,1
BKOS 100-30S	300	100	25,1
BKOS 100-40S	400	100	30,1
BKOS 100-50S	500	100	34,9
BKOS 100-60S	600	100	39,7

⇒ BKV 100
BKDR
BKDR-WZB

S

BKB 100-10S	100	100	2,2
BKB 100-20S	200	100	3,0
BKB 100-30S	300	100	4,0
BKB 100-40S	400	100	5,2
BKB 100-50S	500	100	6,6
BKB 100-60S	600	100	8,3

⇒ KLR
BKBDR
BKBDR-WZB

S

BKB45 100-10S	100	100	1,2
BKB45 100-20S	200	100	1,8
BKB45 100-30S	300	100	2,7
BKB45 100-40S	400	100	3,6
BKB45 100-50S	500	100	5,1
BKB45 100-60S	600	100	6,5

⇒ KLR
BKBDR45
BKBDR45-WZB

I25
I26
I27

I25
I26
I27

I25
I26
I27

G3
I27
I27

G3
I28
I28

При ширине канала от 300 мм рекомендуем устанавливать разделитель. При ширине от 500 мм - два разделителя.

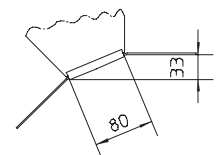
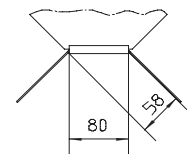
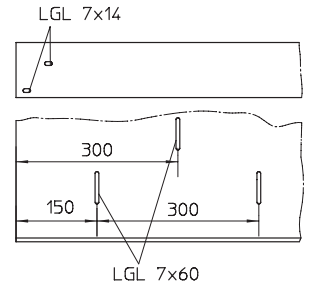

Напольные каналы

ВКА

T-образный отвод

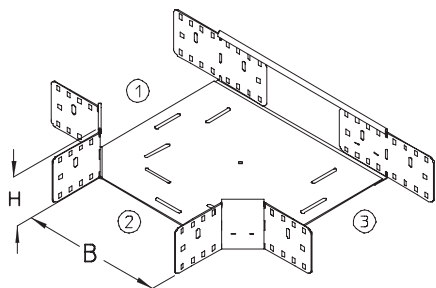

S

	B	H	
	mm	mm	kg
ВКА 100-10S	100	100	3,0
ВКА 100-20S	200	100	4,3
ВКА 100-30S	300	100	5,9
ВКА 100-40S	400	100	7,7
ВКА 100-50S	500	100	8,7
ВКА 100-60S	600	100	12,2

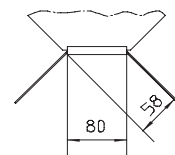

KLR
BKADR
BKADR-WZB



G3
I28
I28

ВКК

X-образный отвод

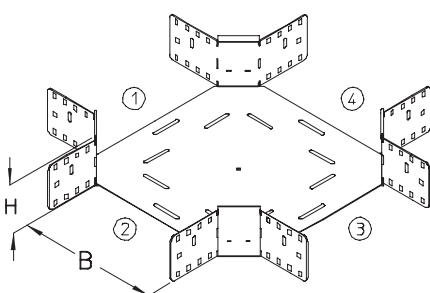

S

	B	H	
	mm	mm	kg
ВКК 100-10S	100	100	3,0
ВКК 100-20S	200	100	4,5
ВКК 100-30S	300	100	6,0
ВКК 100-40S	400	100	7,7
ВКК 100-50S	500	100	9,7
ВКК 100-60S	600	100	12,0

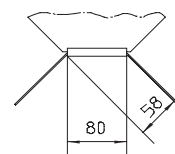

KLR
BKADR
BKADR-WZB



G3
I29
I29

ВКАА

Накладной отвод

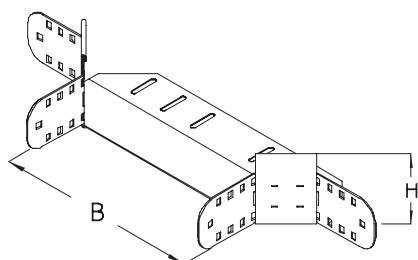

S

	B	H	
	mm	mm	kg
ВКАА 100-10S	100	100	1,8
ВКАА 100-20S	200	100	2,2
ВКАА 100-30S	300	100	2,5
ВКАА 100-40S	400	100	2,8
ВКАА 100-50S	500	100	3,1
ВКАА 100-60S	600	100	3,4



KLR
BKAADR
BKAADR-WZB



G3
I29
I29

Напольные каналы

ВКЕВ
Заглушка

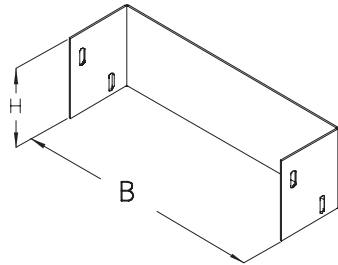

ВКВ 100
Соединитель

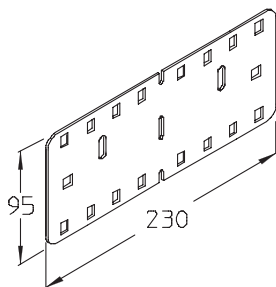

ВКРТ
Разделитель

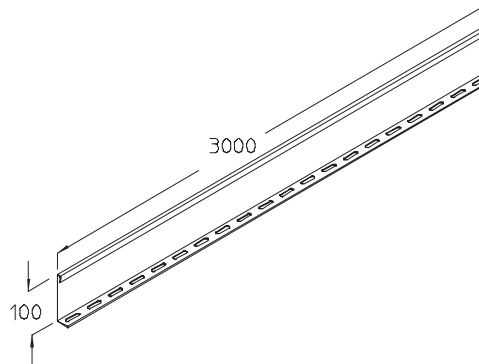

S

ВКЕВ 100-10S
ВКЕВ 100-20S
ВКЕВ 100-30S
ВКЕВ 100-40S
ВКЕВ 100-50S
ВКЕВ 100-60S

B	H	kg
mm	mm	
100	80	0,3
200	80	0,4
300	80	0,5
400	80	0,6
500	80	0,7
600	80	1,0

→ KLR

G3

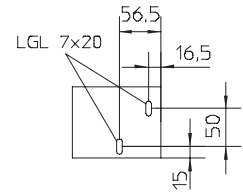

S

ВКВ 100S

Вкл. 2 x KLR

G3

S

ВКРТ 100S

Вкл. 3 x FRSV 6x12
3 x SEMS 6

G8
G11

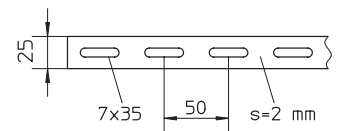

Напольные каналы

BKDU
Опора

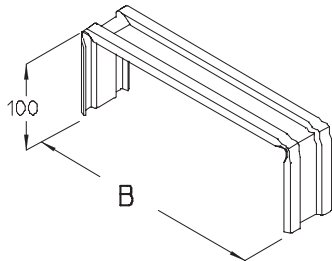

F

BKDU 100-20F
BKDU 100-30F
BKDU 100-40F
BKDU 100-50F
BKDU 100-60F

B
mm

kg

200	0,4
300	0,5
400	0,7
500	0,8
600	0,9

BKDS
Опора

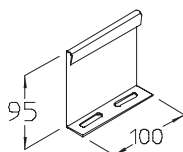

S

BKDS S

0,2

Вкл. 1 x FRSV 6x12
1 x SEMS 6

G8
G11

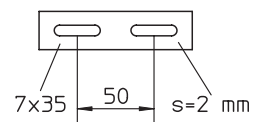

BKDR
Крышка

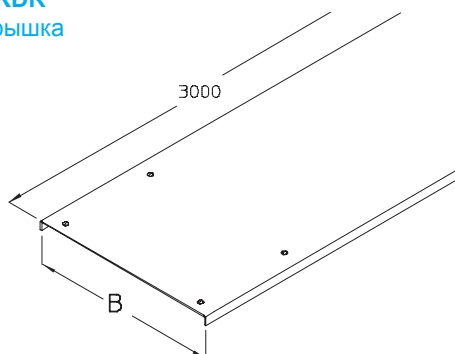

S

BKDR 10S
BKDR 20S
BKDR 30S
BKDR 40S
BKDR 50S
BKDR 60S

100	6,5
200	12,0
300	18,0
400	24,0
500	29,0
600	33,0

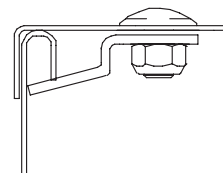

Напольные каналы

BKDR-WZB

Крышка усиленная

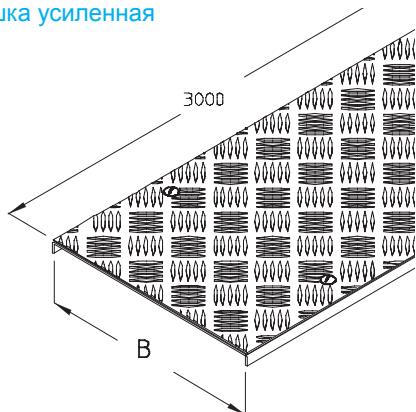

BKBDR

Крышка горизонтального угла

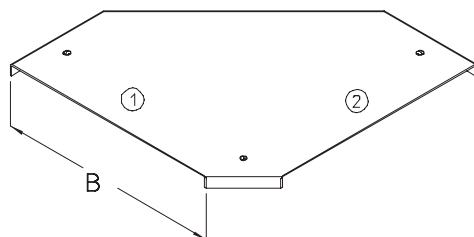

BKBDR-WZB

Крышка горизонтального угла, усиленная

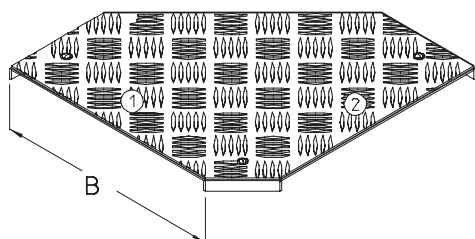

S

	B	
	mm	kg
BKDR-WZB 10S	100	8,2
BKDR-WZB 20S	200	15,2
BKDR-WZB 30S	300	22,2
BKDR-WZB 40S	400	29,2
BKDR-WZB 50S	500	40,5
BKDR-WZB 60S	600	46,9

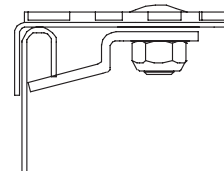

S

	B	
	mm	kg
BKBDR 10S	100	0,5
BKBDR 20S	200	1,1
BKBDR 30S	300	2,0
BKBDR 40S	400	3,2
BKBDR 50S	500	4,6
BKBDR 60S	600	6,3

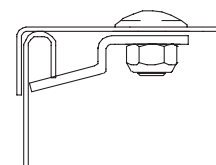

S

	B	
	mm	kg
BKBDR-WZB 10S	100	0,7
BKBDR-WZB 20S	200	1,5
BKBDR-WZB 30S	300	1,8
BKBDR-WZB 40S	400	1,6
BKBDR-WZB 50S	500	6,6
BKBDR-WZB 60S	600	9,1

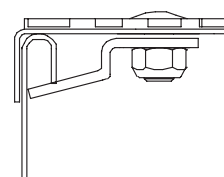

Напольные каналы

BKBDR45

Крышка горизонтального угла

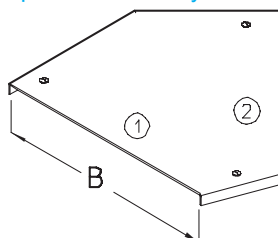

BKBDR45-WZB

Крышка горизонтального угла, усиленная

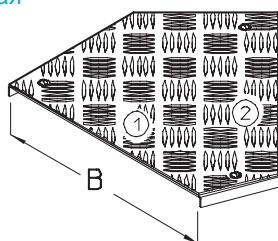

BKADR

Крышка Т-образного отвода

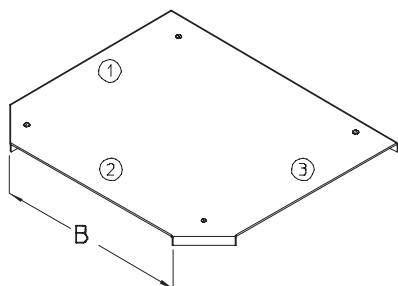

BKADR-WZB

Крышка Т-образного отвода, усиленная

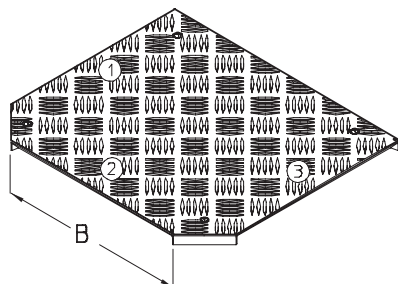

S

	B	
	mm	kg
BKBDR45 10S	100	0,5
BKBDR45 20S	200	0,8
BKBDR45 30S	300	1,2
BKBDR45 40S	400	2,0
BKBDR45 50S	500	2,7
BKBDR45 60S	600	3,6

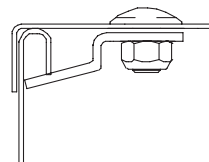

S

BKBDR45-WZB 10S	100	0,6
BKBDR45-WZB 20S	200	1,2
BKBDR45-WZB 30S	300	1,7
BKBDR45-WZB 40S	400	2,9
BKBDR45-WZB 50S	500	3,9
BKBDR45-WZB 60S	600	5,3

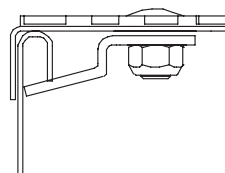

S

BKADR 10S	100	0,8
BKADR 20S	200	1,5
BKADR 30S	300	2,6
BKADR 40S	400	4,1
BKADR 50S	500	5,8
BKADR 60S	600	7,9

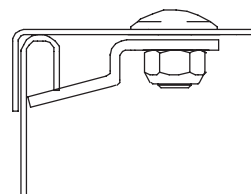

S

BKADR-WZB 10S	100	1,0
BKADR-WZB 20S	200	2,1
BKADR-WZB 30S	300	3,7
BKADR-WZB 40S	400	5,9
BKADR-WZB 50S	500	8,5
BKADR-WZB 60S	600	11,6

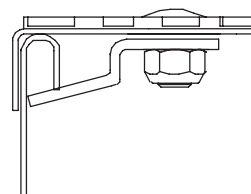

Напольные каналы

BKKDR

Крышка X-образного отвода

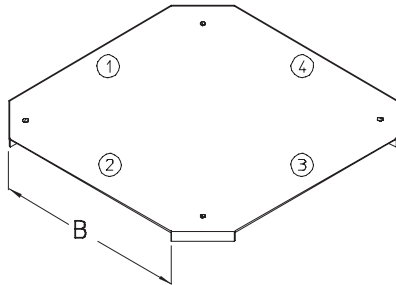

BKKDR-WZB

Крышка X-образного отвода, усиленная

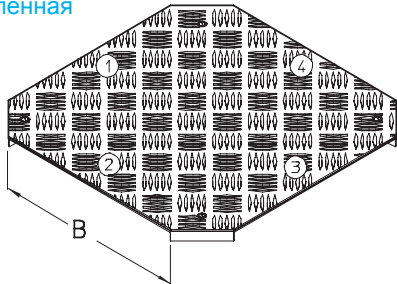

BKAADR

Крышка накладного отвода

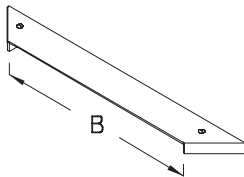

BKAADR-WZB

Крышка накладного отвода, усиленная

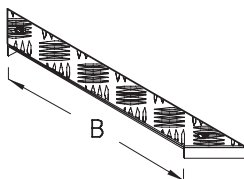

S

	B	
	mm	kg
BKKDR 10S	100	0,9
BKKDR 20S	200	1,7
BKKDR 30S	300	2,9
BKKDR 40S	400	4,4
BKKDR 50S	500	6,2
BKKDR 60S	600	8,3

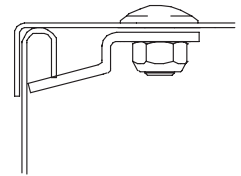

S

BKKDR-WZB 10S	100	1,1
BKKDR-WZB 20S	200	2,4
BKKDR-WZB 30S	300	4,1
BKKDR-WZB 40S	400	6,4
BKKDR-WZB 50S	500	9,0
BKKDR-WZB 60S	600	12,1

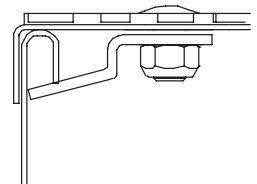

S

BKAADR 10S	100	0,3
BKAADR 20S	200	0,4
BKAADR 30S	300	0,5
BKAADR 40S	400	0,6
BKAADR 50S	500	0,6
BKAADR 60S	600	0,7

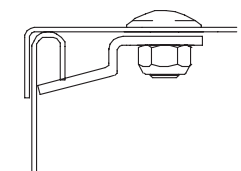

S

BKAADR-WZB 10S	100	0,4
BKAADR-WZB 20S	200	0,6
BKAADR-WZB 30S	300	0,7
BKAADR-WZB 40S	400	0,8
BKAADR-WZB 50S	500	0,9
BKAADR-WZB 60S	600	1,1

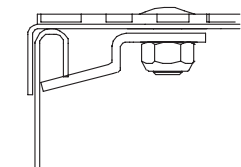

Напольные каналы

БКЗ
Z-образный разделитель

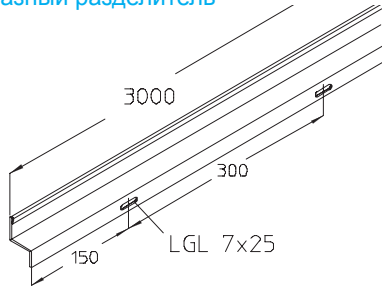

БКН
Напольная консоль

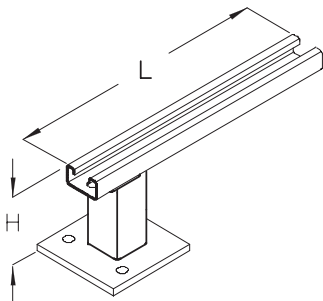

КНА 41
С-профиль

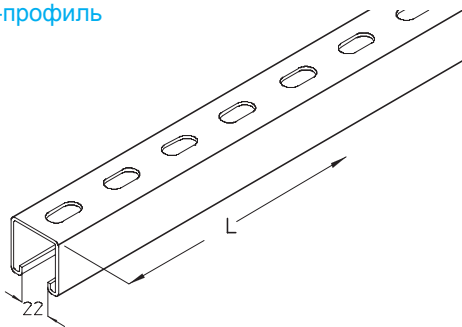

КНЗ
Стенка напольного канала

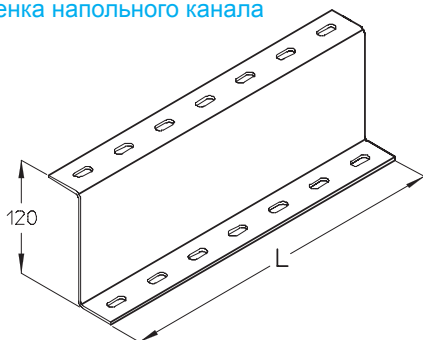

S

БКЗ S

Вкл. 3 x FRSV 6x12
3 x SEMS 6

F

БКН 10F

БКН 20F

БКН 30F

⇒ SD
AM18

F

КНА 41-01F

КНА 41-02F

КНА 41-03F

КНА 41-04F

КНА 41-05F

КНА 41-06F

S

КНЗ 120-01S

КНЗ 120-02S

КНЗ 120-03S

КНЗ 120-04S

КНЗ 120-05S

КНЗ 120-06S

КНЗ 120-30S

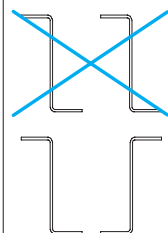

При монтаже стенки
обращайте внимание на
взаимное расположение.

L	H	
mm	mm	kg

3000		2,2
------	--	-----

G8
G11

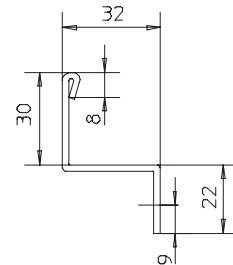

100	110	0,8
200	110	1,0
300	110	1,2

G5
G13

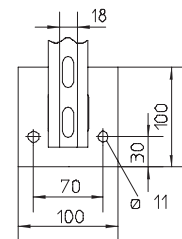

100	0,3
200	0,5
300	0,8
400	1,1
500	1,3
600	1,6

$W_y = 2,8 \text{ cm}^3$
 $W_z = 4,4 \text{ cm}^3$

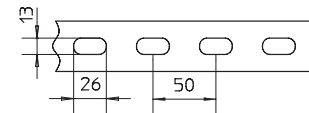
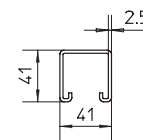

100	0,4
200	0,9
300	1,3
400	1,8
500	2,2
600	2,6
3000	13,1

